

CITY GARDEN

RESIDENCE

VIVA
LAMELA 4

SITUACIJA Site plan



POZICIJA STANA Unit location

etaže I, II, III,

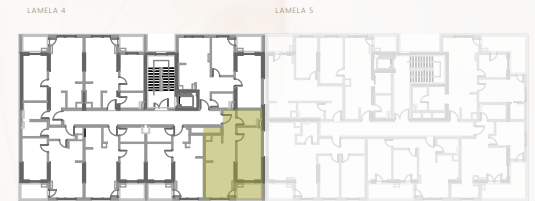

STAN BR. UNIT NO.
S09, S16, S23

DVOSOBAN STAN/
ONE BEDROOM UNIT

1 predulaz:	02.88 m ²
2 kupatilo:	03.10 m ²
3 kuhinja:	03.79 m ²
4 boravak i trpezarija:	17.56 m ²
5 spavaća soba:	14.39 m ²

Površina stana:	41.73 m ²
Površina lođe 6:	03.17 m ²

Ukupna površina: 44.90 m²

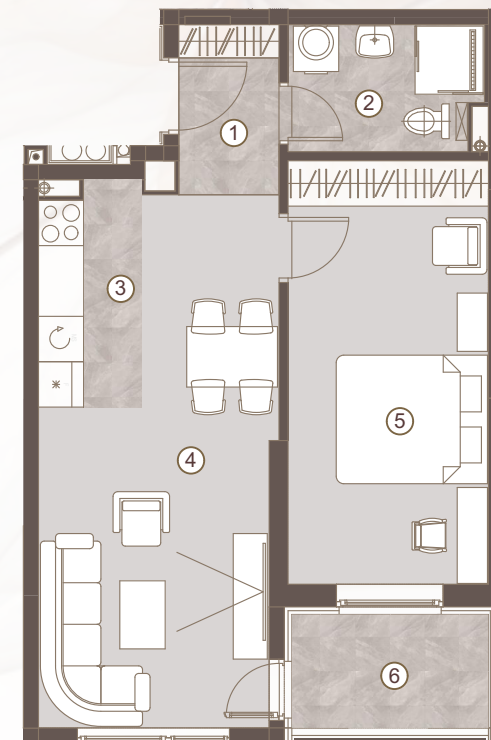

Napomena: Sve dimenzije, površine i grafički prikazi su informativnog karaktera i mogu podlijegati manjim odstupanjima. Površine su obračunate prema glavnom projektu.

Disclaimer: Displayed dimensions, areas, and graphic representations are for informational purposes only and may be subject to minor variations. Floor areas are calculated in accordance with the main project.

